



IP camera with AI video analytics



Model	ZN8-80F12F18NL
Image Sensor	1/1.7" STARVIS CMOS
Sensitivity (AGC ON)	Color: 0.01 Lux @ F2.4 B/W : 0 Lux (IR ON)
Day/Night Mode	IR-Cut automatic filter
Electronic Shutter	1/5 - 1/20.000s.
Aperture	F-Iris
WDR mode	d-WDR
Noise reduction	2D   3D-DNR
Lens	Fixed 1.8mm Viewing angles: H:180°   V: 180°
IR illuminator	IR LED, range up to 15 meters
Video compression	H.265   H.264   MJPEG   Smart Encode
Resolution and refresh rate	Stream 1: 4000x3000 (25 fps) 4096x2160, 3840x2160, 3000x3000, 2560x2560, 1920x1080 (25 fps - 30 fps) Stream 2: 1280x960, D1, 720x720 (25 fps - 30 fps)
Bitrate (CBR/VBR/VBR+)	Stream 1: 500 Kbps ~ 16 Mbps Stream 2: 100 Kbps ~ 8 Mbps
Security	User authentication, hardware WatchDog
Digital functions	HLC   BLC   DEFOG
Corridor mode	Yes (9:16)
Privacy masks	Available
Events	GenSTAR IVS Analytics Support face, character, vehicle detection
Network protocols	TCP, UDP, IPv4/6, HTTP/S, DHCP, ARP, TLS SMTP, DNS, NTP, RTP, RTSP, RTCP, SNMP IGMP/Multicast, UPnP, ICMP, PPPoE, 802.1x
RTSP support	RFC2326 standard (VLC Player / QuickTime).
Compatibility	ONVIF, HTTP CGI

## ZN8-80F12F18NL

### Special features:

- **Smart Encode** - dynamically adaptable network stream and codec parameters for continuous recording while minimizing archive space requirements.
- Built-in **AI-based GenSTAR IVS 2.0** image analytics functions - intrusion, single line crossing, double line crossing, loitering, wrong direction, intelligent motion detection, motion detection (support for accurate vehicle and people detection), people counting, heat maps.
- **ROI** (Region of Interest) - based on user-specified ROI zones (areas of interest), the camera downgrades the image quality outside the zones to reduce transmission bandwidth and storage requirements, while maintaining maximum image quality in the ROI zones.
- **SMART-IR** - the intensity of IR light emitted by IR-LEDs is automatically adjusted to avoid overexposure of objects (e.g. a person's face) near the camera.
- **Scheduling of the image sensor** - the ability to configure the operation of the image sensor depending on the time or Day/Night mode.
- **IP address filter** - the ability to blacklist and whitelist access to the camera's web interface based on IP address.
- **Dewarping** - a digital Fisheye camera straightening function implemented on the camera side.

### Technical parameters

Ethernet interface	10/100 Base-T, RJ45
AUDIO	1 x EC / 1 x WY
ALARM	1 x EC / 1 x WY
Analog output	N/A
Operating temperature	-40°C ... +60°C
Operating humidity	<90%
Reset button	YES
SD card support	YES (max. 1TB)
Power supply / power consumption	12VDC or PoE / Max. 9W
Dimensions / weight	130mm x 38.3mm / 500g
Leakage class	IP66
Built-in microphone	YES

## External dimensions

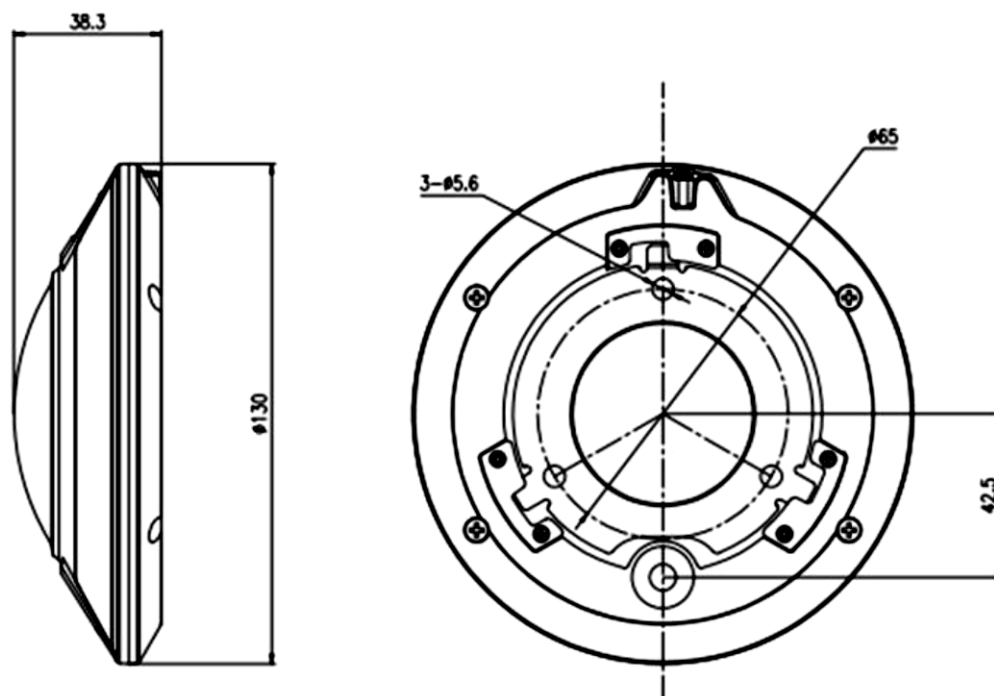

## Camera mounting accessories



ZA8-CBK645E



ZA8-CBK101



ZA8-CBK102



ZA8-CBK501