



IP camera with video analytics with  
face/person/vehicle detection function



## ZN8V-71E5M213D-M

### Special features:



- **Smart Encode** - dynamically adaptable network stream and codec parameters for continuous recording while minimizing archive space requirements.
- **ROI** (Region of Interest, up to 8 zones) - based on user-specified ROI zones (areas of interest), the camera downgrades the image quality outside the zones to reduce bandwidth occupancy (bitrate), while maintaining maximum image quality in the ROI zones.
- Supports **face/person/vehicle** detection
- **SMART-IR** - the intensity of IR light emitted by IR-LEDs is automatically adjusted to avoid overexposure of objects (e.g. a person's face) near the camera.
- **True-WDR** - digital wide-dynamic function.
- **Scheduling** of the image **sensor** - the ability to configure the operation of the image sensor depending on the time or Day/Night mode.
- **Corridor mode** - 90° image rotation in 16:9 aspect ratio
- **NDA compliance** - the device complies with the US congressional act called the "National Defense Authorization Act."
- **Built-in microphone** for audio communication.

Model	ZN8V-71E5M213D-M
Sensor	1/2.7" CMOS
Sensitivity (AGC ON)	Color: 0.01lux @ F1.6 / B/W: 0 Lux with IR
Day/Night Mode	IR-Cut automatic filter
Electronic Shutter.	1/5 - 1/20.000
Aperture	Auto-Iris
WDR mode	True WDR
Noise reduction	2D / 3D-DNR
Lens	From 2.7 to 13.5mm, h102.3° - 33.1, v54.3° - 18.5°
Illuminators	IR range up to 40 meters
AV compression	H.265   H.264   MJPEG   G.711U   G.711A   RAW
Bitrate (CBR/VBR)	Stream 1: 200 Kbps - 12 Mbit
	Stream 2: 100 Kbps - 6 Mbit
	Stream 3: 100Kbps - 3 Mbit
Resolution and frames	2880x1620, 2304x1296, 1920x1080, 1280x720 (25/30 fps).
	D1, VGA, CIF (25/30 fps).
	VGA, CIF, QVGA (25/30 fps).
Image settings	Rotation, saturation, brightness, contrast, sharpness
Digital functions	HLC / BLC / ROI / DEFOG / Aisle Mode
Privacy masks	4 zones
Motion detection	Grid 22x18
IVS events	Intrusion detection, line crossing, double line crossing, moving, wrong direction, illegal parking and intelligent motion detection. Support for alarm triggering by specific types of targets (people and vehicles)
Network protocols	TCP, UDP, IPv4/6, HTTP/S, DHCP, FTP, SMTP,
	DNS, DDNS, NTP, RTP, RTSP, RTCP, Multicast
	Unicast, uPNP, WS-Discovery, SSL, PPPoE
RTSP support	RFC2326 standard (VLC Player / QuickTime).
Security	User authentication, hardware WatchDog
Compatibility	ONVIF profile S, G, M, T HTTP API
Ethernet interface	10/100 Base-T, RJ45
Audio	1x In / 1x Out
Audio compression	G.711 (64kbps), 128Kbps (RAW_PCM)
Microphone	Built-in microphone
Alarm Interface	1x In / 1x Out

### Technical parameters

Reset button	Yes
SD card support	Micro SD / SDHC / SDXC slot, max. 256GB
Power supply	12V DC / PoE (802.3af / class-3)
Power Consumption	Max 6W
Operating Humidity	<90%
Ingress protection	CE / IP66
Dimensions/weight	Ø 140mm (base) x 119.2mm / 0.88kg
Operating temp.	-30°C ~ +60°C
Casing	Metal + Plastic

DORI Distance				
Lens	Detection	Observe	Recognition	Identification
2.7 mm	80 m	32 m	16 m	8 m
13.5mm	208 m	83.2 m	41.6 m	20.8 m

**Adapters  
for installation:**



ZA8-CBK645D



ZA8-CBK101

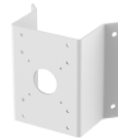

ZA8-CBK102



ZA8-CBK501

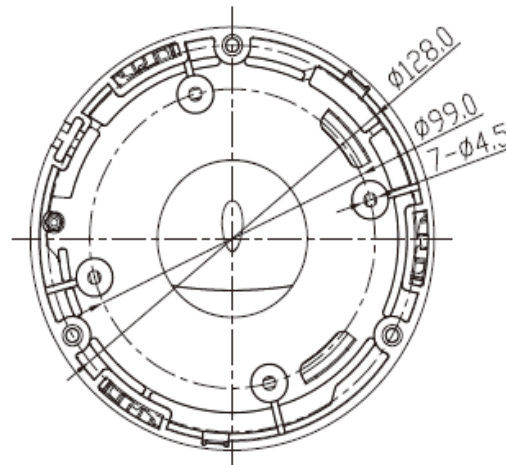
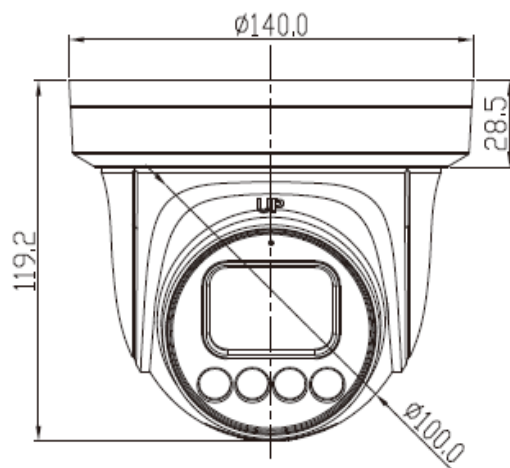

**Compatibility:**



GenSTAR NVR



CORTROL VMS



NDA Directive